



CONSTRUCTION ALERT

Date: December 7, 2017

What: Crane Setup & Chiller Demolition – Parking Lots 4, 6 & 11

When: 12/21/17 – 12/22/17

Where: Santa Ana College - Parking Lots 4, 6 & 11 - Buildings A, D & F

Work Hours: 5:00 AM – 3:00 PM

Activities:

Please be advised that on December 21 – 22, 2017, old chillers will be removed from the roofs of Buildings A, D, & F. Below is a summary of construction activity and impacts to the campus.

Date	Day	Time	Activity/Impacts
12/21/17	Thursday	All Day 5:00 AM – 3:00 PM	<u>BUILDING A</u> <ul style="list-style-type: none"> • Lot 4 will be closed off for the crane. • Building A to be completely vacated for safety reasons. • Removal of old insulation piping and chilled water pumps from the roof.
12/22/17	Friday	All Day 5:00 AM – 3:00 PM	<u>BUILDING D</u> <ul style="list-style-type: none"> • Northwest side of Lot 6 will be closed off for the crane. • Building D to be completely vacated for safety reasons. • Removal of old insulation piping and chilled water pumps from the roof.
12/22/17	Friday	All Day 5:00 AM – 3:00 PM	<u>BUILDING F</u> <ul style="list-style-type: none"> • Northeast side of Lot 11 will be closed off for the crane. • Building F to be completely vacated for safety reasons. • Removal of old insulation piping and chilled water pumps from the roof.

Attachment:
Campus Map

BRISTOL MARKETPLACE SHOPPING CENTER

Closed for Crane
Thursday, 12/21/17

17th Street

17th Street

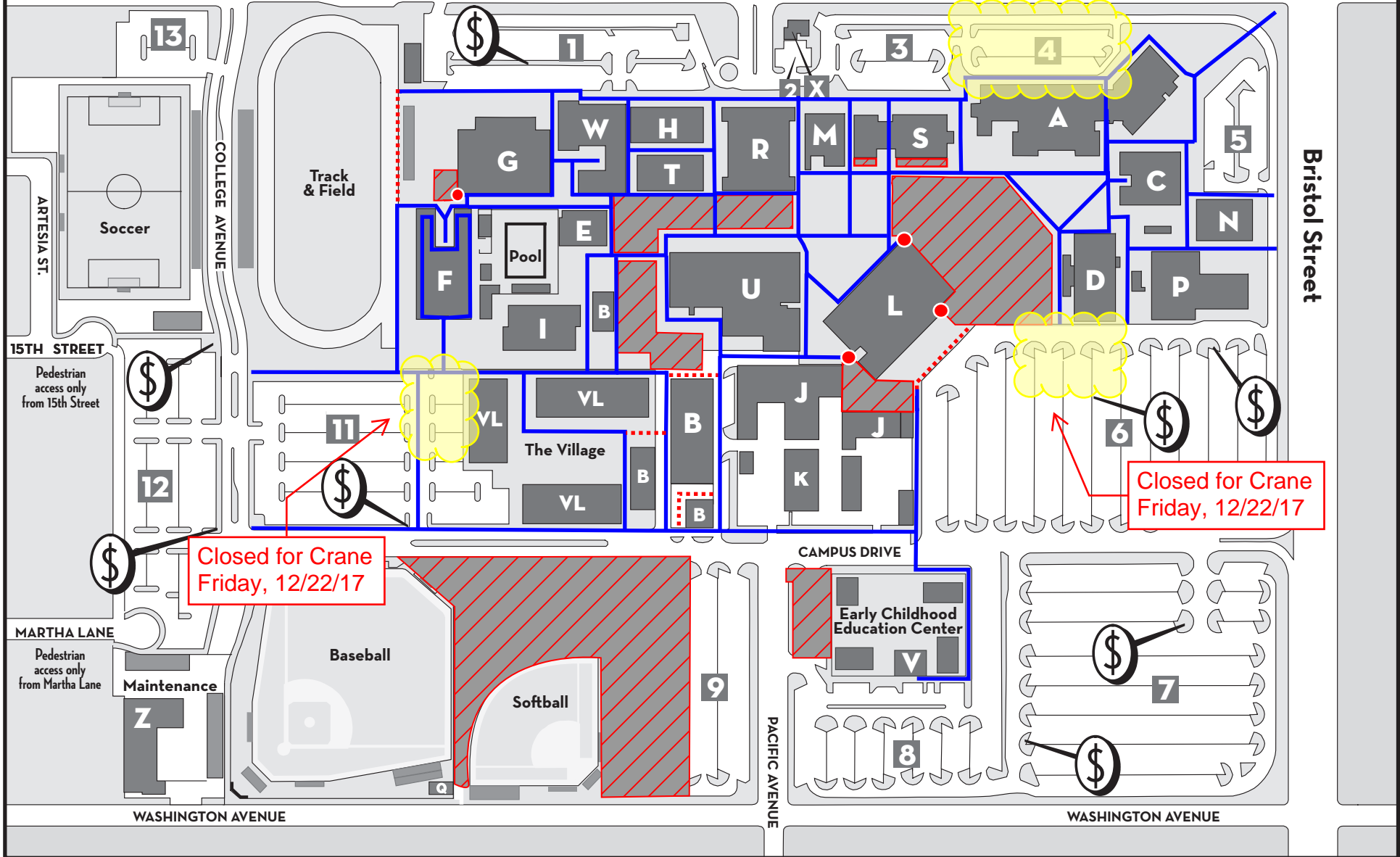

Closed for Crane
Friday, 12/22/17

Closed for Crane
Friday, 12/22/17

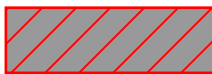

Closed for
Construction

● No Access/Dead End

— Primary Access Route

- - - Alternate Access Route